

# Infrared Receivers

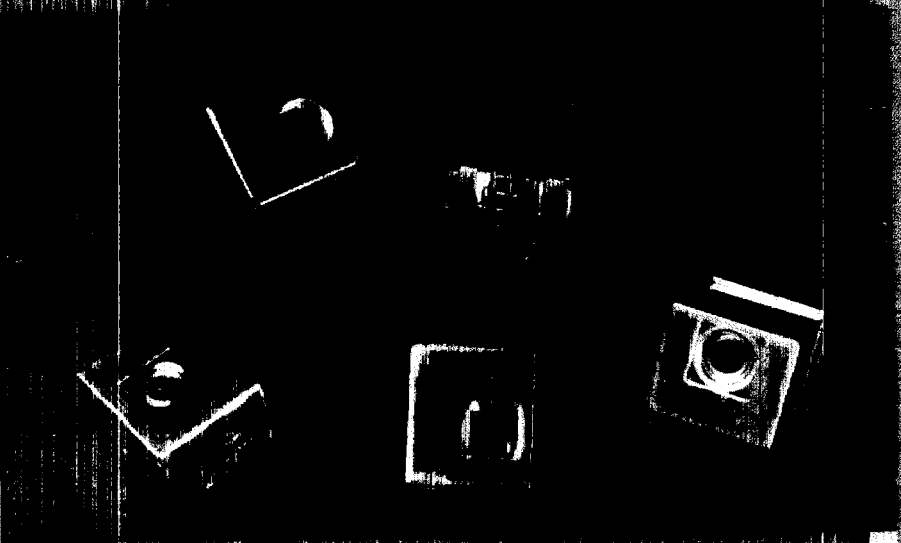

**A/D ELECTRONICS, INC.**

1 800 828 8888  
KADELS002x



# Remote Control Receiver

## 1. Introduction

The receivers consist of an ultraminiaturized infrared remote control module containing a pin photo diode and a signal processing circuit made into one completed RC filter system. Applicable for any appliance requiring a remote control.

## 2. Features

- Easy to handle small type module
- High sensitive

## 3. Application

- TV, VCR, Cassette Recorder, Stereo, and Air Conditioner, etc.

## 4. Characteristics

Characteristics	Min.	Typ.	Max.	Characteristics	Min.	Typ.	Max.
Supply Voltage/Vcc(V)		5	15	Operating Temp/Topr (°C)	-10		+60
Supply Current/Icc(mA)		3		Storage Temp/Tstg (°C)	-20		+75
Detecting Distance/L(m)	10			Resonance Frequency/fO (KHz)		33, 36.7, 56	
Detecting Angle/ $\Delta\theta$ (deg)		$\pm 30$		Output Signal		Active Low	

## 5. General Coding of R/M

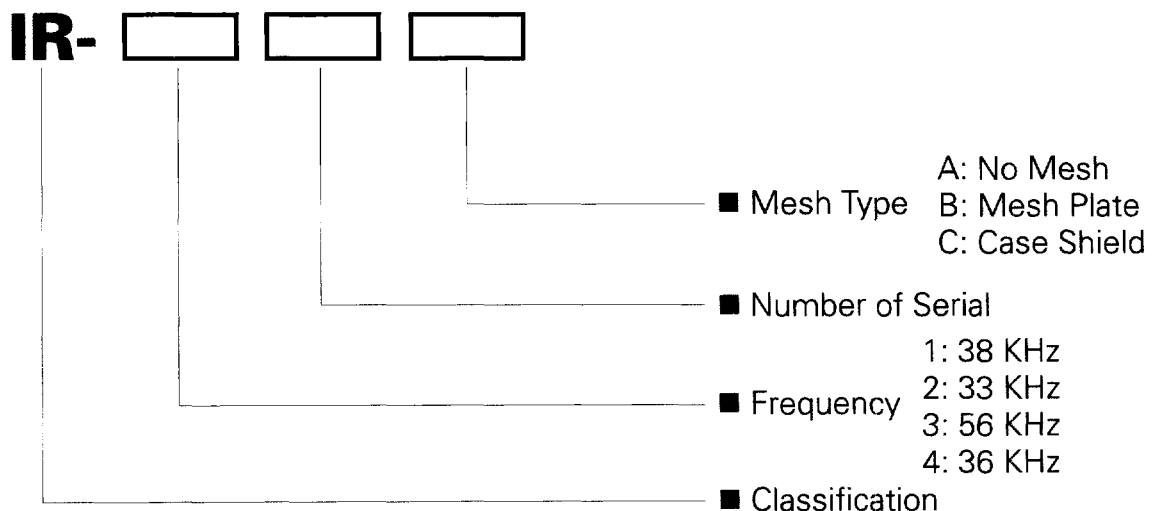



# Remote Control Receiver

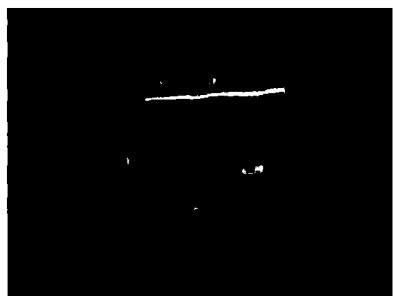

### IR-11A

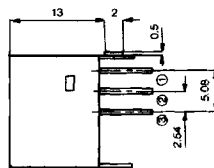
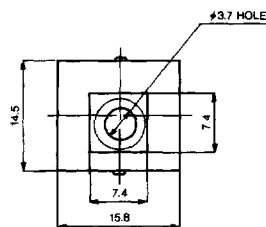

PIN 1	GND
PIN 2	V <sub>OUT</sub>
PIN 3	V <sub>CC</sub>

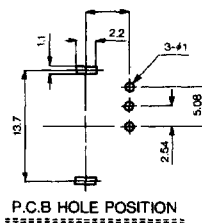
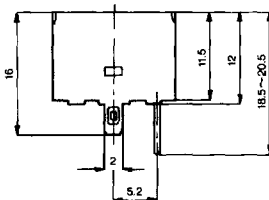

### IR-12A



PIN 1	V <sub>CC</sub>
PIN 2	V <sub>OUT</sub>
PIN 3	GND

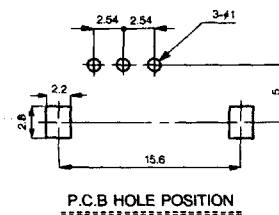
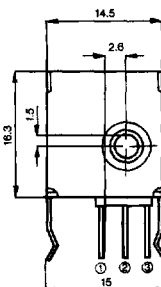
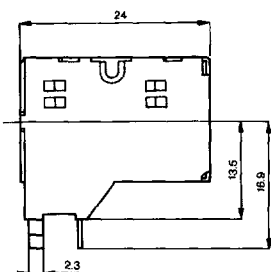

### IR-13A

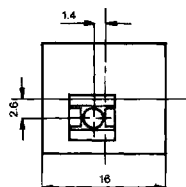

PIN 1	GND
PIN 2	V <sub>OUT</sub>
PIN 3	V <sub>CC</sub>

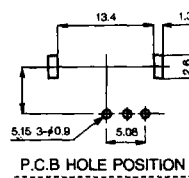
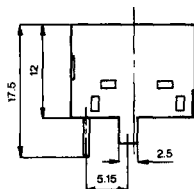
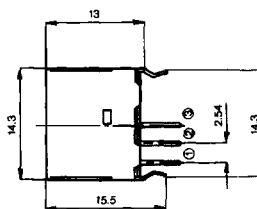



# Remote Control Receiver



**IR-15C**

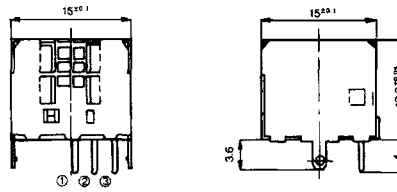

PIN 1	VOUT
PIN 2	VCC
PIN 3	GND

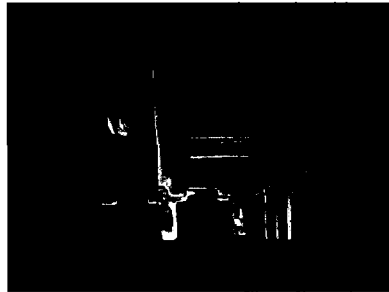
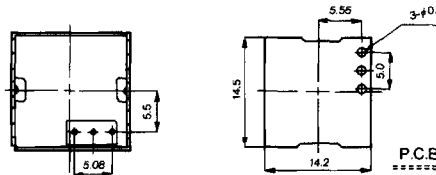

**IR-17A**

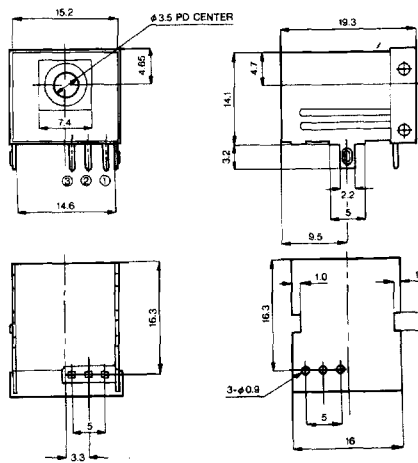

PIN 1	GND
PIN 2	VCC
PIN 3	VOUT

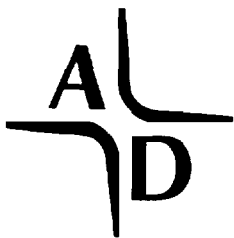

# ELECTRONICS, Inc.

**10421 Burnham Dr. N.W., Bldg. 4,  
Gig Harbor, WA, USA 98332**

**PHONE (253) 851-8005**

**FAX (253) 851-8090**

**<http://www.adelectronics.com>**

**Email: [adinfo@adelectronics.com](mailto:adinfo@adelectronics.com)**